

PRIMARY RECORD

Primary # _____
HRI # _____
Trinomial _____
NRHP Status Code 5S1

Other Listings
Review Code _____ Reviewer _____ Date _____

Page 1 of 1

Resource Name or #: La Pintoresca Park

P1. Other Identifier: Drinking Fountains

P2. Location: Not for Publication Unrestricted
and (P2b and P2c or P2d. Attach a Location Map as necessary.)

a. County Los Angeles

b. USGS 7.5' Quad _____ Date _____ T _____ ; R _____ ; 1/4 of _____ 1/4 of Sec _____ ;

c. Address: 1400 North Fair Oaks City Pasadena Zip 91103

d. UTM: (Give more than one for large and/linear resources) _____ ; _____ mE/ _____ mN

e. Other Locational Data (Enter Parcel #, legal description, directions to resource, elevation, etc., as appropriate)

Parcel No.

P3. Description (Describe resource and its major elements. Include design, materials, condition, alterations, size, setting, boundaries)

Two arroyo stone and concrete drinking fountains are present within La Pintoresca Park. One fountain is located in the center of the west side of the park. The other is in southeast, in front of the library. These features date to the period of significance of the park, 1924 to 1930.

The drinking fountains are cylindrical in shape and their exteriors are arroyo stone set rustically in concrete. The top of each fountain is concrete, as is a low step located to one side. The chrome fountain heads are modern additions. Other drinking fountains in the park are not historic features of the park.

P3b. Resource Attributes:

P4. Resources Present Building Structure Object Site District Element of District Other (Isolates, etc.)

P5a. Photograph or Drawing (Photograph required for buildings, structures, and objects)



P5b. Description of Photo: (View, date, accession #)

P6. Date Constructed/Age and Sources:
 Prehistoric Historic Both

1924 (E)

P7. Owner and Address

City of Pasadena
100 North Garfield Avenue,
Pasadena, CA 91109

P8. Recorded by: (Name, affiliation, and address)

Christy Johnson
McAvoy, Historic Resources Group
1728 Whitley ave., Hollywood, CA 90028

P9. Date Recorded: 06/13/01

P10. Survey Type: (Describe)

P11. Report Citation: (Cite survey report and other sources, or enter "none")

- Attachments NONE Continuation Sheet District Record Rock Art Record Other: (List)
- Location Map Building, Structure, and Object Record Linear Feature Record Artifact Record
- Sketch Map Archaeological Record Milling Station Record Photograph Record

PRIMARY RECORD

Primary # _____
HRI # _____
Trinomial _____
NRHP Status Code 4S2

Other Listings
Review Code _____ Reviewer _____ Date _____

Page 1 of 4

Resource Name or #: La Pintoresca Library

P1. Other Identifier: La Pintoresca Branch Library

P2. Location: Not for Publication Unrestricted
and (P2b and P2c or P2d. Attach a Location Map as necessary.)

a. County Los Angeles

b. USGS 7.5' Quad _____ Date _____ T _____ ;R _____ ; ¼ of _____ ¼ of Sec _____ ;

c. Address: 1355 North Raymond Ave/ 45 East Washington Blvd City Pasadena Zip 91103

d. UTM: (Give more than one for large and/linear resources) _____ ; _____ mE/ _____ mN

e. Other Locational Data (Enter Parcel #, legal description, directions to resource, elevation, etc., as appropriate)

Parcel No.

P3. Description (Describe resource and its major elements. Include design, materials, condition, alterations, size, setting, boundaries)

La Pintoresca Library is a contributing element of the La Pintoresca Park district. This branch public library is housed in a Spanish Colonial Revival style building that is constructed of concrete and irregular in plan. The roof of the building is clad in clay barrel tile. The building is one story with the center of the building being a square, clerestoried mass with six square windows on each face, and one on each of the chamfered corners. Gable-roofed wings extend from the south and east of this central mass. The main mass has a flat roof with a plain parapet. The central clerestory has a hipped roof, with additional flat slopes set in where the roof slopes toward the four chamfered corners of the mass. At the end of each gable face is a small, original ventilation grill below the peak of the roof.

The primary entrance is located between the south and east wings, facing diagonally to the southeast corner entrance to the park, within an arched doorway framed in cast stone. A wrought iron grill decorates the arched transom, and the original oak entrance doors are intact. Between the south, west, and north wings (away from the primary facade) there are (original) infill rooms with shed roofs.

P3b. Resource Attributes: 31 Urban Open Space, 9 Public Utility Building, 30 Tees/Vegetation, other: public library

P4. Resources Present Building Structure Object Site District Element of District Other (Isolates, etc.)

P5a. Photograph or Drawing (Photograph required for buildings, structures, and objects)



P5b. Description of Photo: (View, date, accession #)

P6. Date Constructed/Age and Sources:
 Prehistoric Historic Both

1930 (F) Building Permit

P7. Owner and Address

City of Pasadena
100 North Garfield Avenue,
Pasadena, CA 91109

P8. Recorded by: (Name, affiliation, and address)

Christy Johnson
McAvoy, Historic Resources Group
1728 Whitley ave., Hollywood, CA 90028

P9. Date Recorded: 06/13/01

P10. Survey Type: (Describe)

P11. Report Citation: (Cite survey report and other sources, or enter "none")

- Attachments NONE Continuation Sheet District Record Rock Art Record Other: (List)
- Location Map Building, Structure, and Object Record Linear Feature Record Artifact Record
- Sketch Map Archaeological Record Milling Station Record Photograph Record

The Resources Agency	Primary #
DEPARTMENT OF PARKS AND RECREATION	HRI #
BUILDING, STRUCTURE, AND OBJECT RECORD	

Page 2 of 4

NRHP Status Code 4S2

Resource Name or #: La Pintesca Library

- B1. Historic Name:** La Pintesca Branch Library
B2. Common Name: same
B3. Original Use: Public Library **B4. Present Use:** same
B5. Architectural Style: Spanish Colonial Revival
B6. Construction History: (Construction date, alterations, and date of alterations)

Unknown date, security bars added to windows
 1987, restroom addition on north side

- B7. Moved?** No Yes Unknown **Date:** **Original Location:**
B8. Related Features:

- B9a. Architect:** Bennett and Haskell **b. Builder:** C.E. Tabor
B10. Significance: **Theme:** Public architecture; Community history **Area:** City of Pasadena
Period of Significance: 1930 **Property Type:** Public Library **Applicable Criteria:** A,C
 (Discuss importance in terms of historical or architectural context as defined by theme, period and geographic scope. Also Address integrity).

The La Pintesca Branch Library has local significance, both for its architecture and for its role in the social and intellectual history of Pasadena. It was one of four branch libraries to serve the City through World War II. Pasadena's first major library building opened in 1890, and thirty-seven years later this was replaced with a new building in the new civic center, a Spanish Colonial Revival style building designed by Myron Hunt in 1927. La Pintesca Branch Library was designed by the firm, Bennett and Haskell, in 1930. Bennett and Haskell, along with Edwin Bergstrom, designed the Pasadena Civic Auditorium and the Pasadena Masonic Temple. In addition to being a contributor to the potential local landmark district of La Pintesca Park, the library is individually eligible for Landmark status. The library may become eligible for the National Register at the local level of significance with further research on the context of the public library system in Pasadena.

The four original branch libraries in Pasadena were Hill Avenue (1925, Marston, Van Pelt and Maybury), Santa Catalina (1930, Marston and Maybury), La Pintesca (1930), and Lamanda Park. The first three are intact, and the fourth was replaced in 1967. In the 1950s, four more branches were added to the system for a total of eight. The goal of the City's library program was that no residence in the city should be more than one mile from the nearest public library.

(continued)

- B11. Additional Resource Attributes:** 39 Other: Public Library
B12. References:

- California Department of Parks and Recreation form, La Pintesca Library (45 E. Washington Blvd., Pasadena), 1984.
 --- City of Pasadena, Pasadena Public Library web site, <http://www.ci.pasadena.ca.us/library/>
 --- Lund, Ann Scheid. *Historic Pasadena*. San Antonio, TX: Historical Publishing Network, 1999.
 --- Marcus/Dills. City of Pasadena Survey area 22, La Pintesca Library, April 1982.

(continued)

- B13. Remarks:**

- B14. Evaluator:**
- Christy Johnson McAvoy, Historic Resources Group

Date of Evaluation: 06/13/01

(Sketch Map with north arrow required.)

(This space reserved for official comments.)

State of California – The Resources Agency
DEPARTMENT OF PARKS AND RECREATION
CONTINUATION SHEET

Primary #
HRI #
Trinomial
NRHP Status Code 4S2

Page 3 of 4 **Resource Name or #:** La Pintoresca Library

Continuation Update

D3. Description: *(continued from Primary Record)*

Fenestration throughout is consistent with the later Spanish Colonial Revival style of the building. Two windows are located on each of the wings facing the entrance. These are large, twelve-pane, double-hung sash with wood frames. The ends of the wings have the largest windows, a grouping of three surmounted by an entablature and small corbels. Other fenestration throughout is also wood frame and multipane. The square windows around the clerestory have nine panes. On the end of the west wing, six long, narrow, vertical windows face the open space of the park.

The interior of the building is centered around the clerestoried open space in the center of the plan. The circulation desk is located here, and the wings are occupied by the adults' and children's reading rooms and the adults' and children's book stacks. The interior maintains high integrity, with wood trusses, ceilings, shelving, and original oak furnishings intact. Additional interior spaces include rest rooms, a community room, kitchen, and offices. The basement is used by the Parks and Recreation Department. An addition of two bathrooms to the northwest corner of the building, completed in 1987, are compatible and reversible.

Significance, *(continued from BSO Record)*

The predecessor to this library was first established in 1905 in a basement space in the Washington Street Methodist Church, and later moved to a storefront at the corner of Fair Oaks Avenue and Washington Boulevard, very close to the current site. The branch was founded by the Women's Christian Temperance Union and supported by subscription and community fundraising until it became a part of the Pasadena Public Library system. According to a history of La Pintoresca written for the Pasadena Public Library in 1982, throughout its earliest years, the library showed circulation figures that showed the level of interest in books and reading in Northwest Pasadena, as in 1908 when the Branch "registered 579 borrowers and circulated 10,122 books in its first eight months" of operation. Ironically, the growth in circulation declined after the new branch was constructed due to the Depression, which led to a general increase in hardship and unemployment in the neighborhood.

The La Pintoresca Branch responded to the changes in the community, and it has been a center for community activities and involvement since the 1960s. The library has been a remote classroom for elementary school children since the early 1950s. The history of La Pintoresca states:

Throughout the decade of the 1960s the La Pintoresca branch was extremely active. The library was not only a source of books and information but also a place for residents to discuss community problems. The 1967-68 Annual Report, in fact, stated that the library's main objective for the coming year was to make the La Pintoresca branch the center of activities for the gorthwesteomunity. The increasing interest in community activities resulted in more frequent use of the La Pintoresca meeting room by such groups as: the Well Baby Clinic, sponsored by the City's Health Department, P.C.C. (Pasadena City College)-sponsored classes in Black History and Afro-American Sociology, the Women's International League for Peace and Freedom, Head Start Parent groups, and volunteer tutors who provided after school assistance to children at the library.

Arts and ethnic festivals also took place at the library and surrounding park, and the library was able to call on its strong community support to resist several attempts at its closure throughout the 1970s.

Significance, *(continued from BSO Record)*

- Pasadena Public Library, "History of La Pintoresca Branch Library." Not published, 1982.
- "New Library Architects Selected." Pasadena Star News, March 6, 1930.
- "North Branch Library Plan Approved." Pasadena Star News, March 25, 1930.
- "Library Unit Bids Within Estimate." Pasadena Star News, July 20, 1930.
- "Library Unit Built Soon for North." Pasadena Star News, July 25, 1930.

State of California – The Resources Agency
DEPARTMENT OF PARKS AND RECREATION
CONTINUATION SHEET

Primary #
HRI #
Trinomial
NRHP Status Code 4S2

Page 4 of 4 **Resource Name or #:** La Pintoresca Library

Continuation Update

Library, view north of south side



Detail, east facade



PRIMARY RECORD

Primary # _____
HRI # _____
Trinomial _____
NRHP Status Code 5S1

Other Listings
Review Code _____ Reviewer _____ Date _____

Page 1 of 7

Resource Name or #: La Pintesca Park

P1. Other Identifier:

P2. Location: Not for Publication Unrestricted
and (P2b and P2c or P2d. Attach a Location Map as necessary.)

a. County Los Angeles

b. USGS 7.5' Quad _____ Date _____ T _____ ; R _____ ; 1/4 of _____ 1/4 of Sec _____ ;

c. Address: 1400 North Fair Oaks _____ City Pasadena _____ Zip 91103

d. UTM: (Give more than one for large and/linear resources) _____ ; _____ mE/ _____ mN

e. Other Locational Data (Enter Parcel #, legal description, directions to resource, elevation, etc., as appropriate)

Parcel No.

P3. Description (Describe resource and its major elements. Include design, materials, condition, alterations, size, setting, boundaries)

This urban park, set within a turn of the century residential subdivision, is 2.9 acres in size, roughly square in shape, mainly covered in grass, and has many large, mature trees of a variety of species, including a large Moreton Bay Fig. A public library building is a major built feature, located in the southeast corner. Other features of the park include a circuit of meandering paths, sand pits, picnic areas, a pergola, two tennis courts, a small paved parking area, stone retaining walls, drinking fountains, and a building that was originally an electrical substation (in the northeast corner; currently used as a school).

P3b. Resource Attributes: 31 Urban Open Space, 9 Public Utility Building, 30 Tees/Vegetation, other: public library

P4. Resources Present Building Structure Object Site District Element of District Other (Isolates, etc.)

P5a. Photograph or Drawing (Photograph required for buildings, structures, and objects)



P5b. Description of Photo: (View, date, accession #)

P6. Date Constructed/Age and Sources:
 Prehistoric Historic Both

1924-1930 (F)

P7. Owner and Address

City of Pasadena
100 North Garfield Avenue,
Pasadena, CA 91109

P8. Recorded by: (Name, affiliation, and address)

Christy Johnson
McAvoy, Historic Resources Group
1728 Whitley ave., Hollywood, CA 90028

P9. Date Recorded: 06/13/01

P10. Survey Type: (Describe)

P11. Report Citation: (Cite survey report and other sources, or enter "none")

Attachments NONE Continuation Sheet District Record Rock Art Record Other: (List)
 Location Map Building, Structure, and Object Record Linear Feature Record Artifact Record

Sketch Map

Archaeological Record

Milling Station Record

Photograph Record

DPR 523A (1/95) City of Pasadena

State of California – The Resources Agency
DEPARTMENT OF PARKS AND RECREATION
LOCATION MAP

Primary #
HRI #
Trinomial
NRHP Status Code 5S1

Page 2 of 7 **Resource Name or #:** La Pintoresca Park

Continuation Update

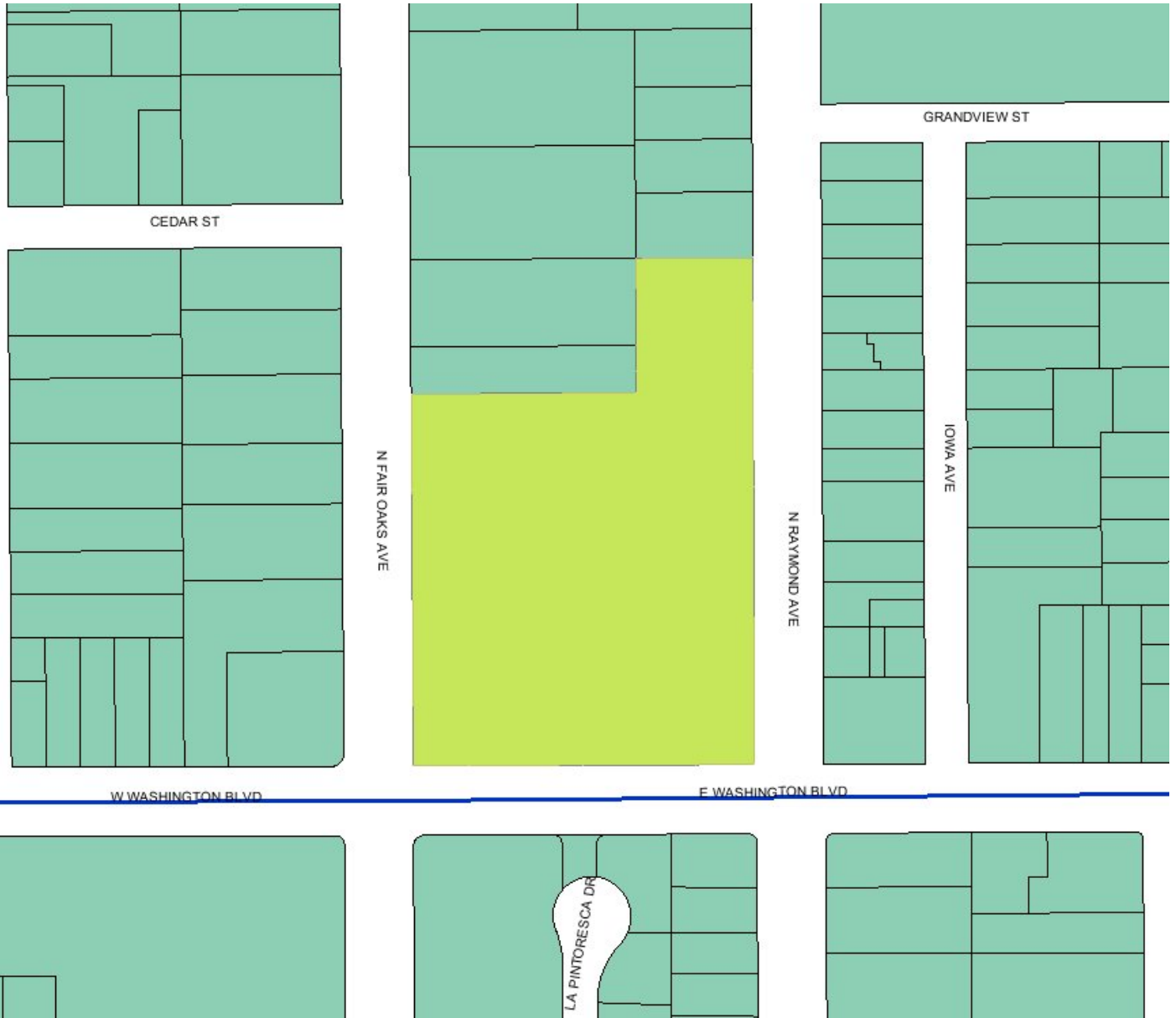

State of California – The Resources Agency
 DEPARTMENT OF PARKS AND RECREATION
DISTRICT RECORD

Primary #
HRI #
Trinomial
NRHP Status Code 5S1

Page 3 of 7 **Resource Name or #:** La Pintesca Park

Continuation Update

D1. Historic Name: La Pintesca Park

D2. Common Name: La Pintesca Park

D3. Detailed Description:

La Pintesca Park is an urban park located in a residential neighborhood. The park has an area of approximately 2.9 acres, including a Municipal Water and Power facility along the north side. The site is level but has a gradual slope upward with the terrain, which is approaching the foothills. Because of a retaining wall around the south, west, and east sides of the park, the streets rise at a steeper rate than the park, which is close to level from north to south.

Most of the park is covered in grass, and serpentine paths paved mainly in asphalt form a circuit around the south, west, and north sides of the park. Trees are concentrated on the south, east, and west sides of the park. The center of the park has fewer, smaller trees, fewer activity areas, and is mostly open and covered in grass.

(continued)

D4. Boundary Description:

The park is bounded by Washington Boulevard on the south, Raymond Avenue on the east, and North Fair Oaks Avenue the west. The north side is bounded by private properties. Legal Description: Portion of lots 8 - I 1, Block N, Painter and Ball Subdivision.

D5. Boundary Justification:

These are the original boundaries of La Pintesca Park when it was laid out in 1924. These have been the boundaries of the park since the period of significance. Although it is included within the city lands, the boundary of the park for purposes of this recordation excludes the Municipal Water and Power station on the northwest part of the property. This building and equipment yard are separated from the rest of the park by a fence and vegetation, and are not features of the park.

D6. Significance: Theme Municipal Park
Period of Significance 1924 – 1930

Area City of Pasadena

Applicable Criteria Pasadena Municipal Code, Chapter 2.75: Criteria A and I

La Pintesca Park appears eligible for City of Pasadena Historic Landmark designation under Criterion A due to its character, interest or value as part of the heritage of the city;" under Criterion I because of its "unique location or singular physical characteristic representing an established and familiar visual feature of a neighborhood," and under Criterion K for "its integrity as a natural environment that strongly contributes to the well-being of people of the City."

Background:

La Pintesca Park was originally the site of the Painter Hotel, later re-named La Pintesca Hotel. The hotel was established in 1888 by Milton Painter, whose father, John H. Painter, was originally from Salem, Ohio, and was one of Pasadena's earlier residents in the 19th century. Painter was also one of four Quakers who established the town of Whittier. Painter was a majority stockholder in the Pasadena Land and Water Company, which was established in 1882 to develop the area around Monk's Hill (in which Painter owned an interest) and the future Painter Hotel site. A street car line (the Pasadena City Railway) extended to the north by John H. Painter's son Alonzo Painter in 1886 brought the potential for more settlers and tourists in the neighborhood. The hotel was built in 1888 by Milton Painter, another son of John H. Painter. Through all of these ventures, the Painter family made a significant contribution to the development of North Pasadena in the early part of the 20th century.

(continued)

D7. References:

- California Department of Parks and Recreation form, La Pintesca Library (45 E. Washington Blvd., Pasadena), 1984.
- City of Pasadena, Pasadena Public Library web site, <http://www.ci.pasadena.ca.us/library/>
- Lund, Ann Scheid. *Historic Pasadena*. San Antonio, TX: Historical Publishing Network, 1999.
- Peterson, Robert H. *Altadena's Golden Years: a Pictorial History of the Early Community*. Altadena, CA: Self-published, 1976.

DPR 523L (1/95) City of Pasadena

State of California – The Resources Agency
DEPARTMENT OF PARKS AND RECREATION
CONTINUATION SHEETPrimary #
HRI #
Trinomial
NRHP Status Code 5S1

Page 4 of 7 Resource Name or #: La Pintesca Park

 Continuation Update**D3. Description:** *(continued from District Form)*

The major historic features of the park are an arroyo stone retaining wall surrounding the site, a wood and concrete pergola on the north side, two arroyo stone drinking fountains, concrete steps, and a number of large, mature trees. Two historic buildings are located in the district: a Spanish Colonial Revival style library building at the southeast corner, and an electrical substation at the northeast corner.

Non-original features of the park include concrete and asphalt paving (paths, parking areas, and area in front of library), two children's play areas and a volleyball sand court. The park sign at the southwest corner is also not an original feature. None of the furniture or fixtures in the park appears to be original.

The level and type of activity within the park varies among its different zones. The northern area of the park is centered around a paved activity area, around the pergola. The pergola is a historic feature of the park, though some of the elements have been replaced. The pergola consists of five square bays defined by concrete piers, which are painted but original features, and a series of wood beams laid north-to-south, which appear to have been replaced. The central bay is covered by a pyramidal hipped roof clad in corrugated metal. In this area, there is a non-historic drinking fountain, a flag pole, a barbecue pit, and an irregularly shaped sand pit with playground equipment. None of these features are historic.

The eastern edge of the park is the most easily accessible, with a low retaining wall along the southern part of its length, and a driveway to the small parking lot adjacent to the library, and a stretch with no retaining wall before it resumes again in front of the former electrical substation. There are a number of large trees along this side of the park that define its edge, along with the regularly-spaced camphor trees in the parking strip. North of the library and parking lot, there are several picnic tables and another children's play area located in the east area of the park.

The southern and western zones of the park have the lowest concentration of activity. The retaining wall continues along the west boundary, with two entrances to the park. The first is near the south end and leads to a flight of concrete steps. The second is to the north and leads to a flat driveway for vehicular access to the park. Both entrances are flanked by square piers that are covered with vines, but appear to be finished in stucco, which is likely an original finish. Both entrances are indicated on 1922 plans and seen in turn of the century photographs. A very large Moreton Bay Fig tree dominates the west side of the park. A non-original sand court used for volleyball is located east of the tree, with the serpentine asphalt path running between them. An arroyo stone drinking fountain is located just south of the base of the Moreton Bay Fig.

In the center of the north side of the park is a pair of tennis courts surrounded by a chain link fence and accessed through a gate near the pergola. Directly to the west of the tennis courts is a Department of Water and Power building and equipment yard on City-owned land. The area is excluded from the district boundaries because it is screened and separated from the park by fencing and vegetation, and was not historically a part of the park; the property was private and occupied by a residence in 1922.

Alterations to the Park

La Pintesca Park retains some features of the site from the time it was a hotel, including the retaining wall around the site and some of the older trees. It also retains many of the features that it was given in 1924, when it underwent a complete transformation in design. These features include the circuit of curving paths, the lawns in the center and trees and lawns around the edges, and the pergola in the north. The final elements added by 1930 were the library and substation.

In 1967, the paths were rebuilt and although they remained close to the original scheme, they were narrowed slightly and the planters that formed islands of plants in the center of the intersections in the path were removed. A 1967 drawing at the City of Pasadena shows an overlay of the old and new paths. The paths today are made up of historic concrete segments (leading from the southwest steps), contemporary concrete segments, and contemporary asphalt segments. Another alteration to the park is the removal of all historic furniture and light standards and their replacement by at least two generations of newer fixtures. Two historic drinking fountains remain.

State of California – The Resources Agency
DEPARTMENT OF PARKS AND RECREATION
CONTINUATION SHEET

Primary #
HRI #
Trinomial
NRHP Status Code 5S1

Page 5 of 7 **Resource Name or #:** La Pintoresca Park

Continuation Update

Significance: (continued from District Record)

The Painter Hotel was sold in 1905 to M. C. Wentworth, and the name was changed to "La Pintoresca." The hotel burned down in 1912, and the City of Pasadena purchased the land in 1915 from C. M. Wooster for \$16,000. According to a contemporary newspaper article ("City Buys Famous Site"), the City intended at that time to include a library in their plans for the site. The library was not constructed there until 1930. Documentation of the 1924 design of the park by Theodore Payne and Ralph Cornell has not been located, after a search of the Pasadena Historical Museum and City of Pasadena archives. Descriptions of the drawing from earlier documentation of the park indicate that the library was originally envisioned for the northwest corner of the park.

Significance under City of Pasadena Criterion A and I:

While the park does not retain enough integrity from the period 1924-1930 to merit National Register listing at the local level of significance, it does appear eligible for designation under the Pasadena Cultural Heritage ordinance. The park is eligible under Criterion A, which states that a property has "character, interest or value as part of the heritage of the city." It is also eligible under Criterion I, which states that a property has a "unique location or singular physical characteristic representing an established and familiar visual feature of a neighborhood and Criterion K which states, "it (has) integrity as a natural environment that strongly contributes to the well-being of people of the City." As an early part of the public parks system, designed by a significant landscape architect, and as the location of the La Pintoresca a Branch Library, its most prominent feature, the park is clearly significant in the history of the City of Pasadena.

Pasadena had a long tradition of ornamental horticulture and an appreciation of the natural and cultivated outdoors, which began with the earliest settlers of the Pasadena colony. Two significant private gardens were located in the city such as Busch Garden (home of Adolphus Busch, opened for public visits after 1906) and Carmelita (the home of Jeanne Carr, a noted and published horticulturist and mentor to John Muir). The earliest public park was established in 1911 when the City began to acquire land in the Arroyo Seco to establish a vast natural park with various cultural and recreational facilities located throughout. The City finished acquiring the land in 1927, and by then had constructed a public pool (1914), the Rose Bowl (1922), a Greek Theater (1924), as well as tennis courts and baseball fields. Significant landscape architects or garden writers who lived in Pasadena including Florence Yoch, Beatrix Ferrand, Helen Van Pelt, Katherine Bashford, and Paul Theine.

In the 1920s the garden courtyard within Pasadena City Hall was laid out, as were two public parks in the northern part of the city: Washington Park and the subject property, La Pintoresca. La Pintoresca was designed by Theodore Payne and Ralph Cornell in 1924 after nine years in use as a public park with a different design. Little remains of the design of the hotel grounds or the pre-1924 park. The arroyo stone retaining wall, however, is an exception. There are two breaks in the west side of the retaining wall, the southern one with stairs and the northern one a driveway. An 1890s photograph of the property (with the Painter Hotel on the site) shows the southern break in the wall with the stairs, and it is also seen in 1922, and in various other drawings throughout the 20th century. From this, one concludes that the retaining wall is the only feature of the property remaining from the hotel era, and that it was incorporated into the design of the park. Today, as it has been since the turn of the century, the wall is covered with vines.

A 1922 drawing in the City of Pasadena archives and an -undated photograph in the Pasadena Historical Museum archives clearly indicate that the land had been developed as a public park prior to the early 1920s. The earlier design of the park (before 1924) had straight paths running north-to-south and east-to-west throughout with grass areas and trees (mostly palin, pine, eucalyptus, and camphor); several basketball, tennis, and roque courts were mostly located in the northern part of the park; and a stone retaining wall like the one seen today ran around the property. The system of curvilinear paths around the site, designed in 1924, changed it dramatically. These allowed access to all areas of the park by path, while leaving the center free as an open lawn. This basic layout is intact, as is one of the main features, the pergola on the north side.

The park and the library, elevated by a retaining wall over Washington Boulevard, are clearly a major physical feature and important open space in the neighborhood. They also reflect the interest of the City in the 1920s through 1930 in the design of its public spaces and buildings. The social and community role of the park and its library are important to the northwestern area of Pasadena as well as to Pasadena in general.

View northeast through park; Moreton Bay Fig tree and stone drinking fountain at left.



View south along Raymond Avenue sidewalk; park and library (center and right).



DPR 523L (1/95) City of Pasadena

State of California – The Resources Agency
DEPARTMENT OF PARKS AND RECREATION
CONTINUATION SHEET

Primary #
HRI #
Trinomial
NRHP Status Code 5S1

View of north and west of library



Retaining wall on the west side of park.



PRIMARY RECORD

Primary # _____
HRI # _____
Trinomial _____
NRHP Status Code 5S1

Other Listings
Review Code _____ Reviewer _____ Date _____

Page 1 of 1

Resource Name or #: La Pintoresca Park

P1. Other Identifier: Pergola

P2. Location: Not for Publication Unrestricted a. County Los Angeles

and (P2b and P2c or P2d. Attach a Location Map as necessary.)

b. USGS 7.5' Quad _____ Date _____ T _____ ; R _____ ; 1/4 of _____ 1/4 of Sec _____ ;

c. Address: 1400 North Fair Oaks City Pasadena Zip 91103

d. UTM: (Give more than one for large and/linear resources) _____ ; _____ mE/ _____ mN

e. Other Locational Data (Enter Parcel #, legal description, directions to resource, elevation, etc., as appropriate)

Parcel No.

P3. Description (Describe resource and its major elements. Include design, materials, condition, alterations, size, setting, boundaries)

The La Pintoresca Park pergola is situated in the center of the north end of the park, running from east to west. The structure resembles many others seen in historic photographs of Pasadena parks, and so appears to have been built to a design used in several of the parks. The structure is supported by twelve pairs of tall, square piers forming five open bays, with wood beams laid between the piers connecting them east to west; smaller wood members then are laid over the beams from north to south. The wood members are not original, though they probably echo the original arrangement. The central bay has a pyramidal roof clad in corrugated metal. The piers are concrete on the exterior, and they appear to have the original finish, although they are currently painted in a manner that is not compatible with their historic character. The roof over the central bay is indicated in drawings from the 1960s to have a tile roof.

Despite its diminished integrity, the structure is an important feature in the park.

P3b. Resource Attributes: 39 Other: pergola

P4. Resources Present Building Structure Object Site District Element of District Other (Isolates, etc.)

P5a. Photograph or Drawing (Photograph required for buildings, structures, and objects)



P5b. Description of Photo: (View, date, accession #)

P6. Date Constructed/Age and Sources:

Prehistoric Historic Both

1924 (E)

P7. Owner and Address

City of Pasadena
100 North Garfield Avenue,
Pasadena, CA 91109

P8. Recorded by: (Name, affiliation, and address)

Christy Johnson
McAvoy, Historic Resources Group
1728 Whitley ave., Hollywood, CA 90028

P9. Date Recorded: 06/13/01

P10. Survey Type: (Describe)

P11. Report Citation: (Cite survey report and other sources, or enter "none")

- Attachments NONE Continuation Sheet District Record Rock Art Record Other: (List)
- Location Map Building, Structure, and Object Record Linear Feature Record Artifact Record
- Sketch Map Archaeological Record Milling Station Record Photograph Record

PRIMARY RECORD

Primary # _____
HRI # _____
Trinomial _____
NRHP Status Code 5S1

Other Listings
Review Code _____ Reviewer _____ Date _____

Page 1 of 1

Resource Name or #: La Pintesca Park

P1. Other Identifier: Retaining Wall

P2. Location: Not for Publication Unrestricted
and (P2b and P2c or P2d. Attach a Location Map as necessary.)

a. County Los Angeles

b. USGS 7.5' Quad _____ Date _____ T _____ ; R _____ ; 1/4 of _____ 1/4 of Sec _____ ;

c. Address: 1400 North Fair Oaks _____ City Pasadena _____ Zip 91103

d. UTM: (Give more than one for large and/linear resources) _____ ; _____ mE/ _____ mN

e. Other Locational Data (Enter Parcel #, legal description, directions to resource, elevation, etc., as appropriate)

Parcel No.

P3. Description (Describe resource and its major elements. Include design, materials, condition, alterations, size, setting, boundaries)

The retaining wall that circles most of La Pintesca Park is the oldest element in the park district. The wall predates the 1924-1930 period of significance, as it was an important part of the site when it was occupied by the Painter (later La Pintesca) Hotel. The wall was incorporated into the later design changes that the site went through as it was converted to a public park.

The wall is constructed of arroyostone and concrete with a concrete coping. The coping is from the period of significance for the park. Most of the face of the wall is covered by thick, creeping ficus.

The openings in the wall date from different ears in the site's history. The northwest and southwest breaks are historic, as are the piers that flank those openings. A break in the south side that led to the front of the hotel was still present in a 1922 site plan, but was probably removed when the park was redesigned in 1924. The opening in the southeast corner, now the park's main entrance and the main path to the library, dates to the 1924-1930 period of significance, and was not yet present in 1922.

P3b. Resource Attributes:

P4. Resources Present Building Structure Object Site District Element of District Other (Isolates, etc.)

P5a. Photograph or Drawing (Photograph required for buildings, structures, and objects)



P5b. Description of Photo: (View, date, accession #)

P6. Date Constructed/Age and Sources: Prehistoric Historic Both

1888 (E) Date of construction of Painter Hotel previously on the site

P7. Owner and Address

City of Pasadena
100 North Garfield Avenue,
Pasadena, CA 91109

P8. Recorded by: (Name, affiliation, and address)

Christy Johnson
McAvoy, Historic Resources Group
1728 Whitley ave., Hollywood, CA 90028

P9. Date Recorded: 06/13/01

P10. Survey Type: (Describe)

P11. Report Citation: (Cite survey report and other sources, or enter "none")

- Attachments NONE Continuation Sheet District Record Rock Art Record Other: (List)
- Location Map Building, Structure, and Object Record Linear Feature Record Artifact Record
- Sketch Map Archaeological Record Milling Station Record Photograph Record

PRIMARY RECORD

Primary # _____
HRI # _____
Trinomial _____
NRHP Status Code 5S1

Other Listings
Review Code _____ Reviewer _____ Date _____

Page 1 of 1

Resource Name or #: La Pintoresca Park

P1. Other Identifier: Electrical Substation

P2. Location: Not for Publication Unrestricted
and (P2b and P2c or P2d. Attach a Location Map as necessary.)

a. County Los Angeles

b. USGS 7.5' Quad _____ Date _____ T _____ ; R _____ ; 1/4 of _____ 1/4 of Sec _____ ;

c. Address: 1400 North Fair Oaks _____ City Pasadena _____ Zip 91103

d. UTM: (Give more than one for large and/linear resources) _____ ; _____ mE/ _____ mN

e. Other Locational Data (Enter Parcel #, legal description, directions to resource, elevation, etc., as appropriate)

Parcel No.

P3. Description (Describe resource and its major elements. Include design, materials, condition, alterations, size, setting, boundaries)

This one-story building is currently used as a school, but was originally constructed as an electrical substation. As noted in the Primary Record, the architects of the building were Bennett and Haskell, who also designed the library directly to the south two years later. The building is constructed of concrete and finished in smooth stucco. The style is a pared-down, utilitarian Beaux-Arts, with a square plan, a hipped roof clad in clay tile, and corner quoins. A molding around the exterior provides a string course to set off the plain frieze at the top of the walls below the overhang of the roof. The symmetrical primary façade faces south into the park, and has a central entrance with a non-original door and full-length side lights. Two window openings are located on the south façade, one to either side of the door. The single pane casement windows in these are not original. The secondary facade faces Raymond Avenue. This facade has four equal-sized window openings concentrated toward the south end of the facade with original multipane, steel frame sash. A non-significant addition is attached to the west facade. A former transformer yard to the west of the building now provides a play yard for the school occupying the building. A low wall of arroyo stone with a concrete coping located along the sidewalk resembles the wall around the remainder of the property and may be part of the site's original circuit of retaining walls.

P3b. Resource Attributes: 9 Public Utility Building

P4. Resources Present Building Structure Object Site District Element of District Other (Isolates, etc.)

P5a. Photograph or Drawing (Photograph required for buildings, structures, and objects)



P5b. Description of Photo: (View, date, accession #)

P6. Date Constructed/Age and Sources:
 Prehistoric Historic Both

1928 (E), 1982 DPR Form

P7. Owner and Address

City of Pasadena
100 North Garfield Avenue,
Pasadena, CA 91109

P8. Recorded by: (Name, affiliation, and address)

Christy Johnson
McAvoy, Historic Resources Group
1728 Whitley ave., Hollywood, CA 90028

P9. Date Recorded: 06/13/01

P10. Survey Type: (Describe)

P11. Report Citation: (Cite survey report and other sources, or enter "none")

- Attachments NONE Continuation Sheet District Record Rock Art Record Other: (List)
- Location Map Building, Structure, and Object Record Linear Feature Record Artifact Record
- Sketch Map Archaeological Record Milling Station Record Photograph Record